

To replace the sprag clutch

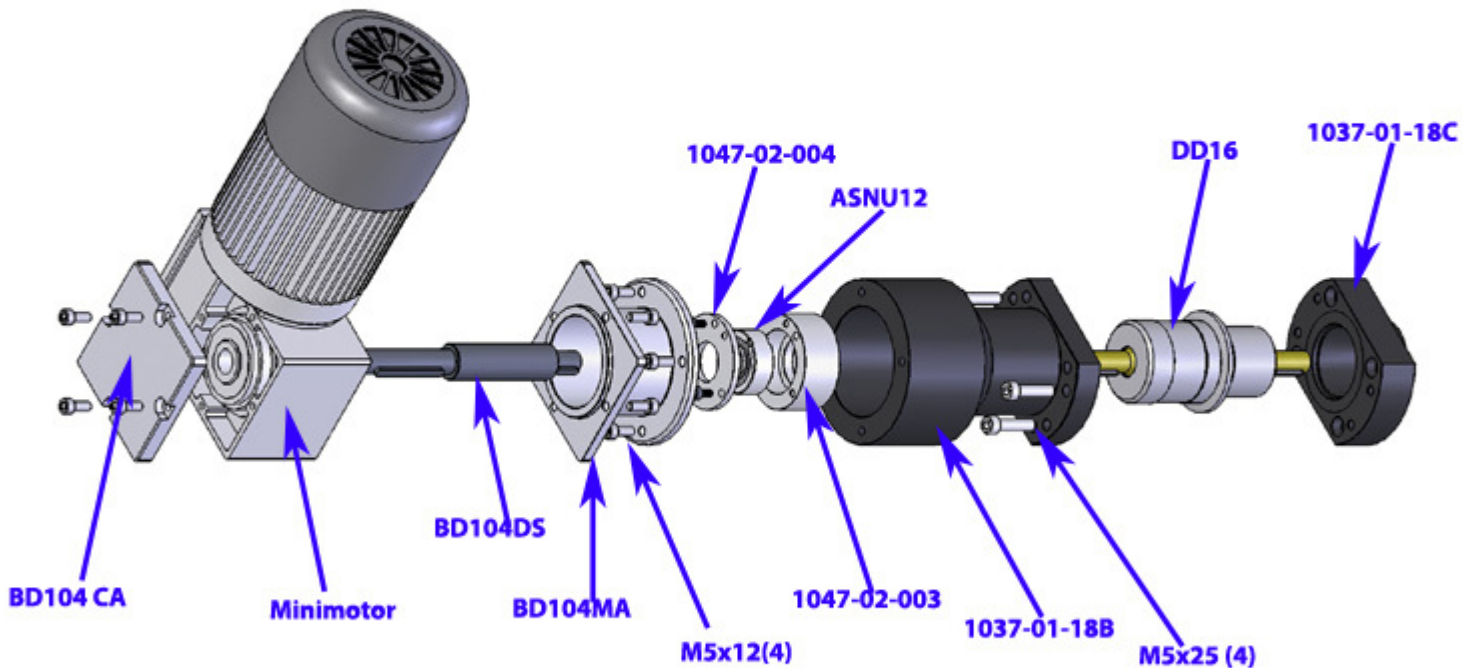

Rotary Drive Assembly



- 1) Remove the 4 bolts that hold the silver motor adaptor to the housing 1037-01-18B
- 2) Pull the motor clear and pull out the sprag clutch housing 1047-02-004
- 3) Remove the 3 socket headed screws holding the two halves of the housing together
- 4) Establish which way around the sprag clutch is working before removal
- 5) Pull the top of the housing off and remove the sprag clutch ANSU12
- 6) Put the new sprag clutch into the housing the correct way around
- 7) Replace the top ensuring that the locating tabs fit into the clutch and the housing
- 8) When aligned tighten the 3 allen screws
- 9) Fit the clutch assembly into the drive housing ensuring the drive key is aligned
- 10) Re-fit the motor ensuring the drive key is aligned with the center of the clutch